

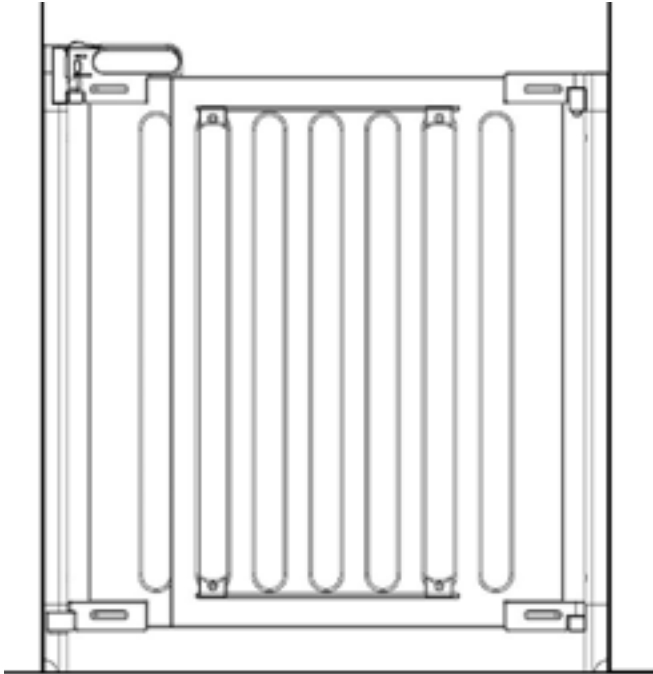

A HIGHER STANDARD OF SAFETY™

USER GUIDE

Spectrum - Hardware Mount



Height 30" (76 cm)

Minimum Opening 29.2" (74 cm)

Maximum Opening 40.5" (103 cm)

IMPORTANT: Qdos wants to keep your children safe and for that we need you to do your part by carefully reading and following the instructions below. Please read through the instructions before starting the installation.

For installation videos and FAQ go to: [QdosSafety.com](https://www.QdosSafety.com)

IMPORTANT!

PLEASE READ AND FOLLOW THESE INSTRUCTIONS CAREFULLY AND KEEP FOR FUTURE REFERENCE

When installed between two strong and rigid surfaces and according to these instructions, this gate has been tested to meet or exceed the following Safety Standards, US- ASTM F-1004, Canada- SOR/90-39, and European- EN 1930.

⚠ WARNING

- To prevent serious injury or death, securely install gate and use according to manufacturer's instructions.
- Install according to manufacturer's instructions
- Intended for use with children from 6 months up to 24 months of age.
- NEVER use to keep child away from pool.
- NEVER use with a child able to climb over or dislodge/open the gate.
- This product will not necessarily prevent all accidents. NEVER leave child unattended.
- Use only with the locking mechanism securely engaged.
- Regularly check all hardware and do not use if any part of gate is broken or missing.
- NEVER step or climb over the gate, always open to pass through.
- For indoor use only.
- Fits openings 29.2-40.5" (74-103 cm)

HELP?

To help you install your gate quickly and easily, please go to qdossafety.com for installation videos and FAQ's to help you succeed. You may also contact our customer service at Info@qdossafety.com or by phone at 800-593-5522.

MAINTENANCE AND CLEANING

Check the gate regularly to ensure all the hardware and mountings are tightened. Clean using a mild soap and wipe with a damp cloth.

WARRANTY

Your Qdos product is warranted to be free from manufacturing defects in material or workmanship for a period of 1 year from date of purchase, when used under normal conditions and in compliance with these instructions.

Qdos will either repair, or at its own option replace, free of charge, any parts necessary to correct any defect in material or workmanship during the warranty period.

USE LOCATIONS

This gate can be used on top of or at the bottom of stairs, as well as inside and in front of doorways and openings when installed between two strong and rigid surfaces.

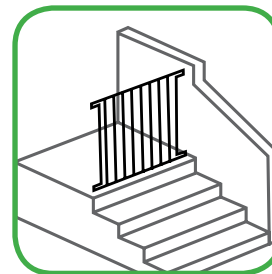

top of stairs

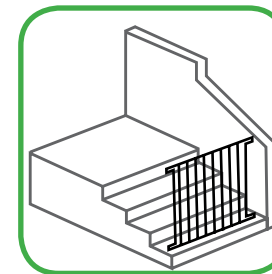

bottom of stairs

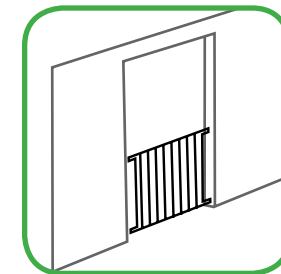

doorway/opening

OPENING SIZE AND ANGLE MOUNTING

The Spectrum will fit in openings from 29.2-40.5" (74-103 cm). The size of the gate is adjustable by sliding the two gate panels.

Besides the normal perpendicular mounting, the Spectrum gate can be mounted at any angle within 180 degrees. This allows the gate to be mounted inside the opening, in between odd angled locations, as well as in front of openings.

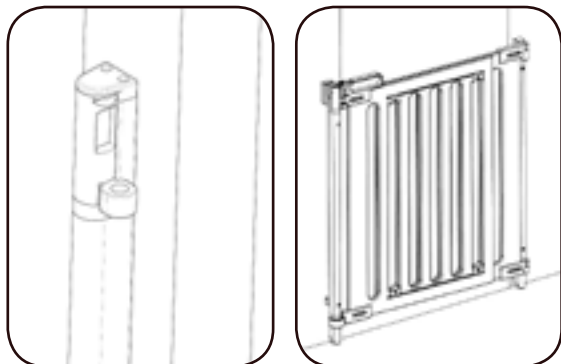

| Opening Size | Where to clamp gate together (Top and Bottom) |
|----------------------------|---|
| 29.2"-32.25" (73-82 cm) | |
| 32.25"-35" (82-89 cm) | |
| 35"-38" (89-97 cm) | |
| 38"-40.5" (97-103 cm) | |

BASEBOARD AND QUARTER ROUND INSTALLATION

General

This gate may be installed at the top and bottom of stairs, in openings and doorways, that are strong and rigid with a smooth and clean mounting surface. For challenging installation situations and surfaces, one or more of the following installation accessories might be necessary to use for a secure installation.

If the baseboard height is 4.25" or less you can use the included Baseboard Spacers for a vertical installation of the Hinge and Locking FastMount™ Rails. See page 13.

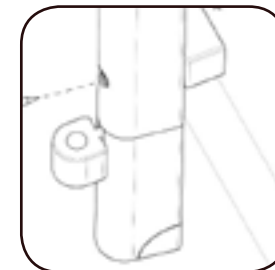

If there is a quarter round present, remove the quarter round insert at the bottom of the FastMount™ Rail as described in Step 1 before installation.

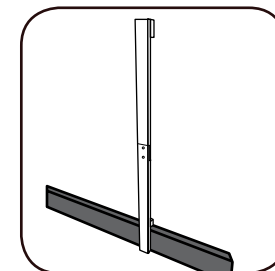

Qdos Universal Baseboard Kit -

If the baseboard is more than 4.25" tall you will need to use the Qdos Baseboard Kit in order to create a vertical mounting surface. Works for baseboards 7/8" (22 mm) thick and 7" (22 cm) tall.

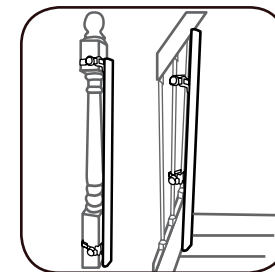

Qdos Universal Stair Mounting Kit -

If installing on banisters or spindles.

PART LIST:

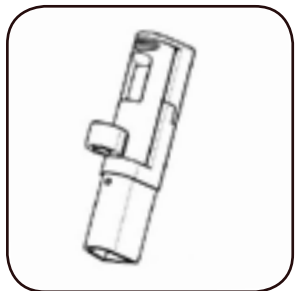

Top Lock

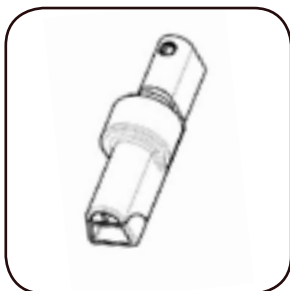

Bottom Lock

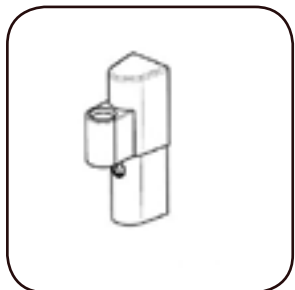
FastMount™
LOCKING Rail
(One screw hole)

Top Hinge

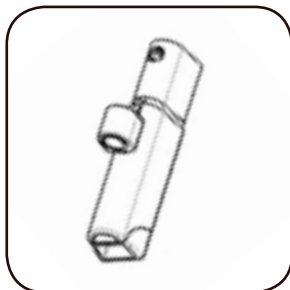

Bottom Hinge

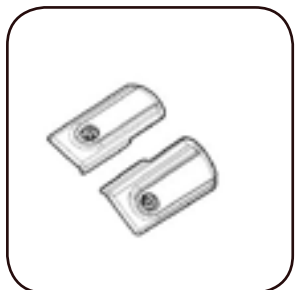
FastMount™
HINGE Rail
(Two screw holes)

2x One-Way Stop

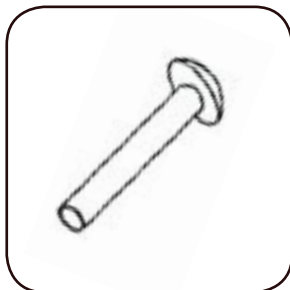
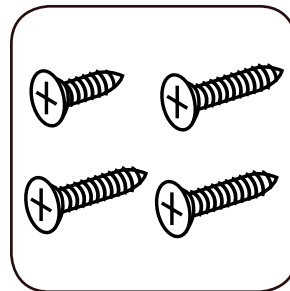
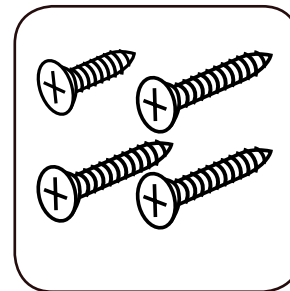
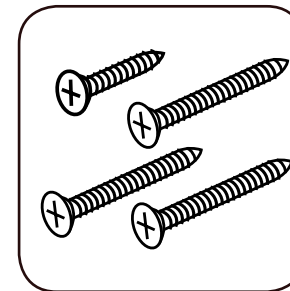
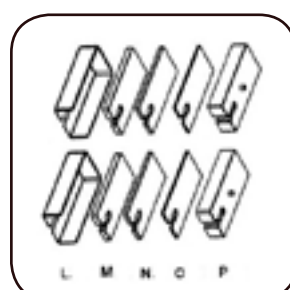
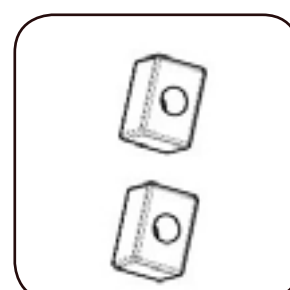
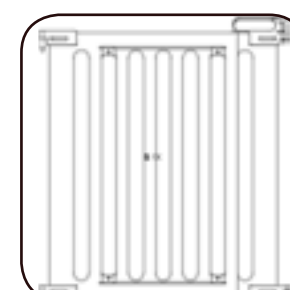
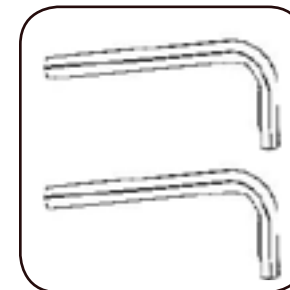
Extra Socket Screw
for One-Way Stop3x Short 2''
(50 mm) Screw
1x Shorter screw3x Medium 2.75''
(70 mm) Screw
1x Shorter screw3x Long 3.25''
(85 mm) Screw
1x Shorter screwTop Baseboard
Spacers2x Bottom
Baseboard SpacersGate Panel,
pre-assembled

2 Allen Wrenches

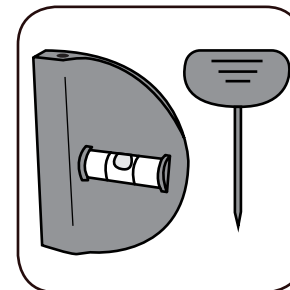
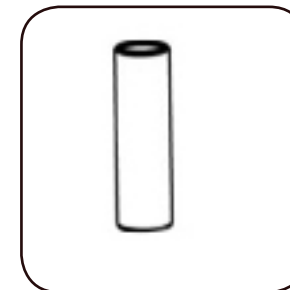
Installation Level
with Marking Tool

Removal Tool

Step 1

Identify the rail with only one hole in it. With the hole towards the bottom, push the Top Lock into the top of the FastMount™ Locking Rail until the plastic tab snaps into place on the back of the rail (Picture A). Push the Bottom Lock into the bottom of the Locking Rail until the plastic tab snaps into place on the back of the rail (Picture B).

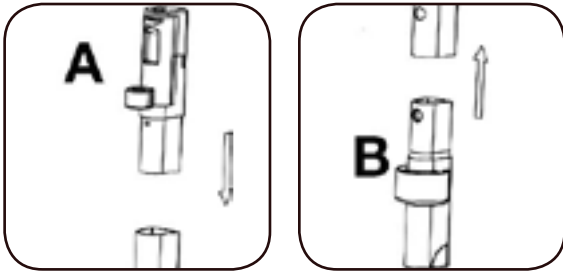

IMPORTANT:

- If you are mounting on a wall with quarter round molding on the floor, pull out the Quarter Round Spacer from the bottom of the Bottom Lock.
- If you are mounting on a wall that has a baseboard, please see Page 13 how to use the included baseboard spacers.

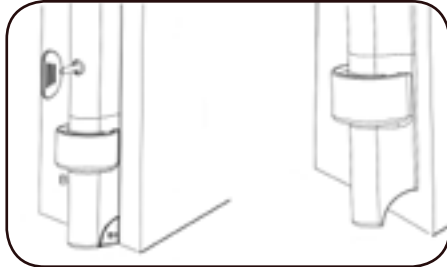

Step 2

Repeat Step 1 for the Top and Bottom Hinge pieces on the FastMount™ Hinge Rail.

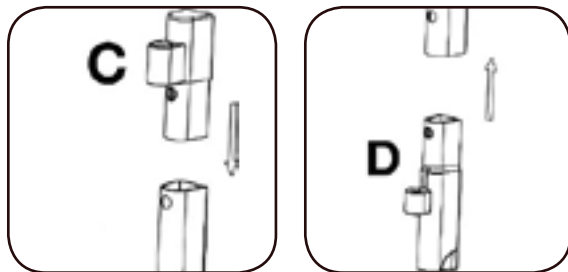

IMPORTANT:

REGARDING THE INCLUDED MOUNTING SCREWS! Before marking where to attach the gate, make sure you have a solid surface for mounting the gate to. The included screws are intended for the following locations.

Directly into wood

The Short 2" (50 mm) Screws are used when mounting directly onto wood, for example in a door frame or other framed opening. If installing into hardwood, first drill a pilot hole. The shorter screw in the pack is used for the top of the FastMount™ Locking Rail.

Into a stud behind drywall

Use stud-finder to locate where there is a stud behind the drywall. Then use the Medium 2.75" (70 mm) Screws to mount the gate into the stud. If attaching the gate using Baseboard Spacers, see page 12, use the Long 3.25" (85 mm) Screws to secure into the stud. The shorter screw included in both packs used for the top of the FastMount™ Locking Rail.

Any other surface

If mounting into drywall, brick or other surface, use only the appropriate hardware for that surface. Consult with a certified child proofer, a handyman or your local hardware store if you are unsure. Never mount into cavity wall or hollow brick.

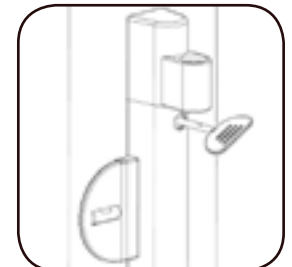

Step 3

With the FastMount™ Hinge Rail resting on the floor in the desired location, use the provided Installation Level to make sure it is vertical. Use the Marking Tool to mark the 2 screw locations.



Remove the protective liner from the adhesive tape on the level so that the level can be attached to the rail.

Step 4

Remove the screws that hold the top cover on the Top Lock and remove the top cover, as well as the Main Lock for access to the upper screw hole.

Repeat Step 3 for the Locking Rail.

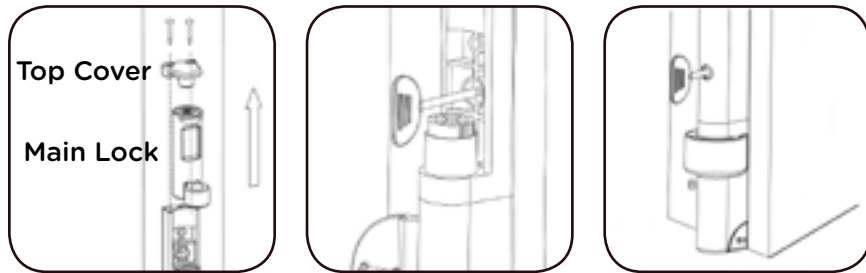

Step 5

Attach the rails using the appropriate screws per above.

Step 6

As the gate can be mounted at any angle within 180 degrees, make sure to reinstall the Main Lock, so it points directly toward the Hinge rail.

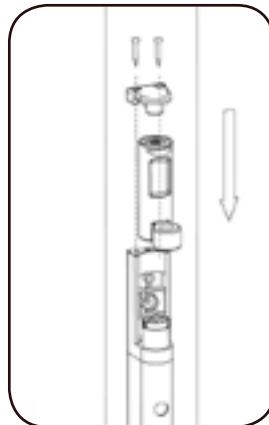

Install the Top Cover and insert the screws to hold it in place.

Step 7

Based on your opening size, determine the size your gate needs to be in the sizing chart on page 4.

To adjust the size of the gate, remove the 4 clamps using the Allen Wrenches. Reposition the gate panels to the desired width.

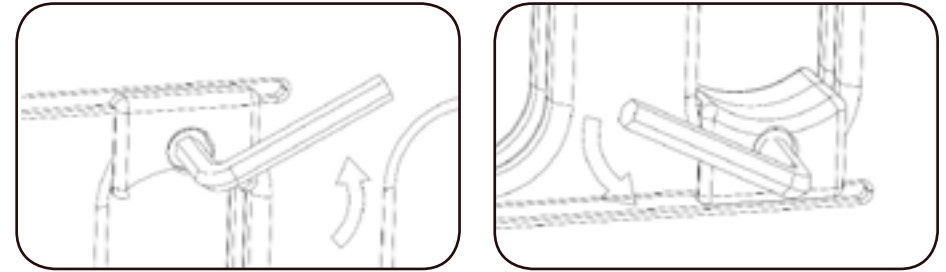

Replace the clamps in the outer positions where the panels overlap and tighten with the Allen Wrenches. Make sure the clamps line up in the grooves on the panels.

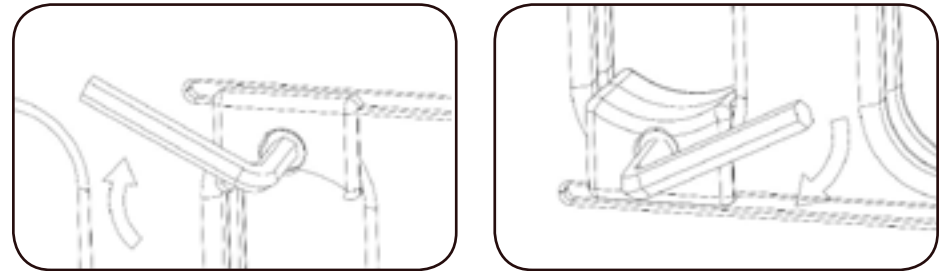

Step 8

Using the Allen Wrenches, loosen up the screws holding the two hinges and the two locks so they can be adjusted sideways.

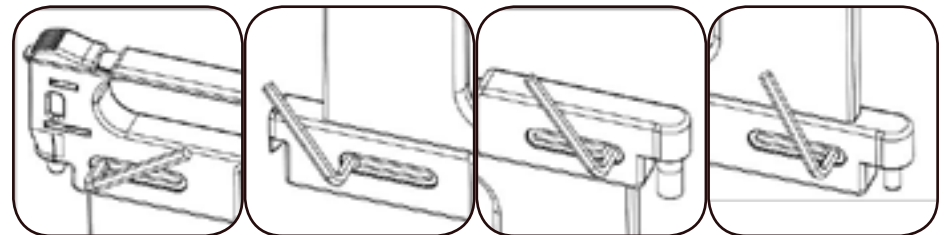

Step 9

Gently hang the gate on the hinges. Adjust the width of the hinges and locks until the locking side reaches the locks on the rail. Now lift the gate up and guide it over locks. When correctly lined up push down on the handle until it locks.

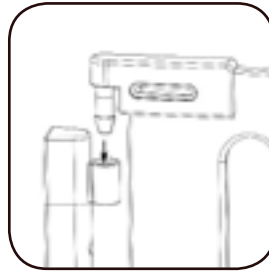

Step 10

Fine tune the position of the hinges and locks so the gate is centered in the opening. Tighten the screws in the hinges and locks.

GATE OPERATION

To open the gate slide back the locking latch on the handle and at the same time lift the gate and open the door.

To close and lock the gate, lift the gate handle and line up the Top and Bottom Locks, then simply push down and the At-A-Glance Indicator™ will switch to green indicating that it is locked.

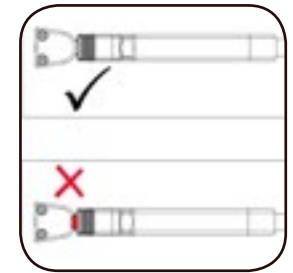
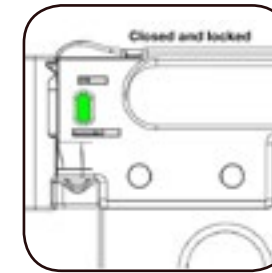
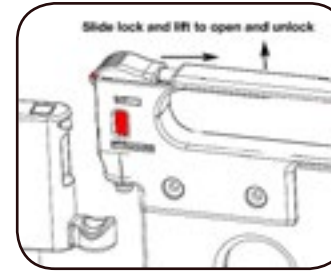

USING INCLUDED BASEBOARD SPACERS

If there is a baseboard present where you want to install the gate, measure the height of the baseboard from the floor.

- If the height is 4.25" (10.8 cm) or less you can use the included Baseboard Spacers for a vertical installation of the Hinge and Locking FastMount™ Rails.
- If the height is more than 4.25" (10.8 cm) tall, you will need the Qdos Baseboard Kit in order to create a vertical mounting surface. The kit can accommodate baseboards up to 7" (18 cm) tall.

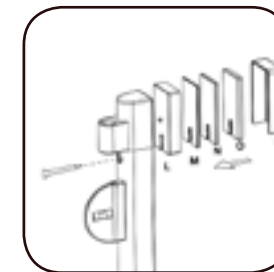
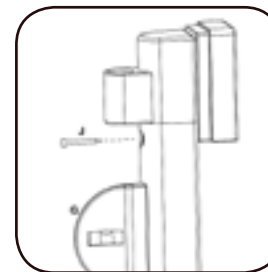
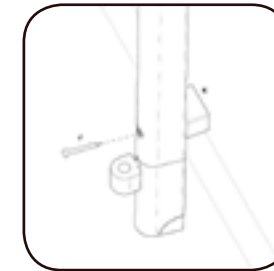
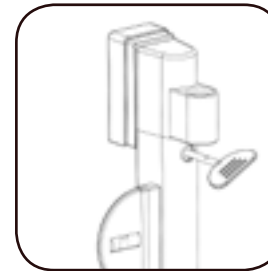

Use a stud-finder to find the location of a stud to screw into. Follow Step 3 and 4 to mark the hole locations on the wall.

Line up the Lower Baseboard Spacer with the lower hole and using one of the

Long 3.25" (85 mm) Screws and attach it loosely.

Attach the peg in spacer L to the back of the Top Hinge. Using one of the Long 3.25" (85 mm) Screws attach it loosely to the wall.

Move the level to the front of the rail. Insert the thick spacer (O) inside the Top Cover (P) and slide down behind spacer L until they rest on the screw. Now push the rail against the wall and check if it is vertical. If not vertical, remove Top Cover and use any combination of the spacers (M,N,O) until the rail is vertical.

Finally tighten both screws firmly.

Then continue with instructions from Step 6.

ONE WAY STOP

The One-Way Stop must always be used when the gate is used at the top of stairs to prevent the gate from swinging out over the stairs. It can also be used in any other location where you want to restrict the opening direction.

The one-way stop is attached on the lower side of the handle. There is one right-hand stop and one left-hand stop.

There are two options for attaching the One-Way Stop.

A- If the handle has not been adjusted sideways, use the Allen Wrenches to remove the screw holding the handle. Attach the correct One-Way Stop for the side you have chosen to have the gate open with the "lip" lining up with the bottom of the handle and replace the screw.

B- If the handle has been adjusted out, then use the Extra

Socket Screw and attach the One-Way Stop in the slot as close to the rail as possible.

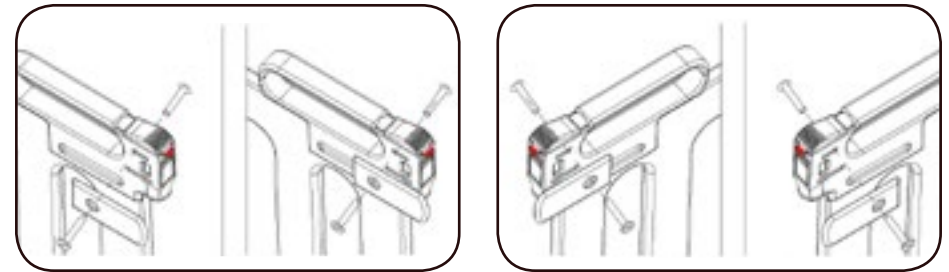

TEMPORARY OR PERMANENT REMOVAL OF GATE

If you need to temporarily or permanently remove the gate, you can do so by using the provided Removal Tool.

Slide the Removal Tool into the underside of the Top Hinge. The Removal Tool will compress the locking tabs and be held in place. The gate can now be lifted off the hinges.

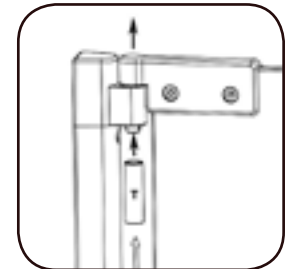

Keep the Removal Tool in a secure place for when needed.



**3350 Town Point Drive, Suite 100
Kennesaw, GA 30144 USA
1-800-593-5522 • www.QdosSafety.com
©2016 Regal Lager, Inc. All rights reserved.
Made to Qdos Standards in China.**

02/2017